

Please rate this document after reviewing at the bottom of this page.

INSPECTION

Check the pads for excessive wear, discs for run out and wear, and calipers for fluid leakage.

Front Brake

Front brake disc thickness check

1. Check the brake pads for wear and fade.
2. Check the brake disc for damage and cracks.
3. Remove all rust and contamination from the surface, and measure the disc thickness at 8 points, at least, of same distance (5mm) from the brake disc outer circle.

Front brake disc thickness

- 17 in Standard : 28.0 mm (1.10 in.)
 - 17 in Service limit : 26.4 mm (1.04 in.)
 - 18 in Standard : 30 mm (1.18 in.)
 - 18 in Service limit : 28.4 mm (1.11 in.)
- Deviation: Less than 0.005mm (0.0002in.)

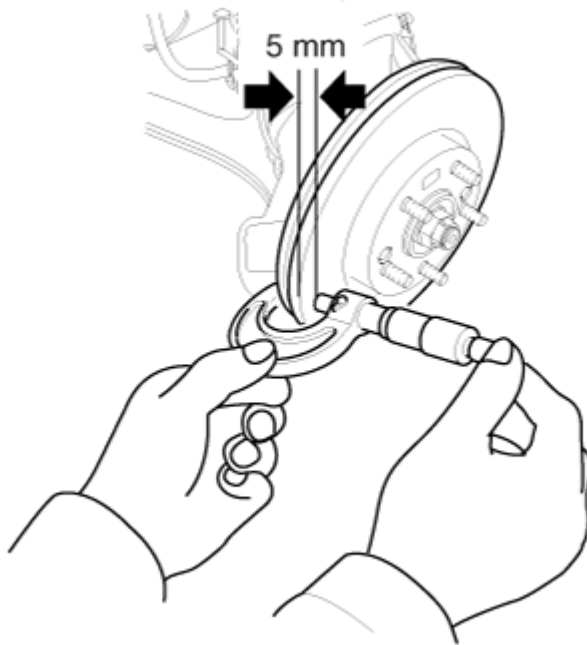

4. If wear exceeds the limit, replace the discs and pad assembly left and right of the vehicle.

Front Brake Pad Check

1. Check the pad wear. Measure the pad thickness and replace it, if it is less than the specified value.

Pad thickness

- 17 in Standard value: 9.0 mm (0.35 in)
- 18 in Standard value: 11.0 mm (0.43 in)
- 18 in Service limit: 2.0 mm (0.0787 in.)
- 17, 18 in Service limit: 2.0 mm (0.0787 in.)

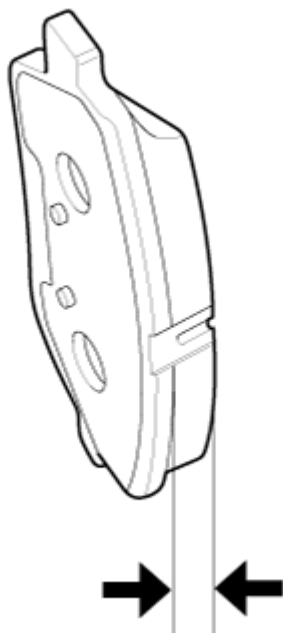

2. Check that grease is applied, to sliding contact points and the pad and backing metal for damage.

Front brake disc runout check

1. Place a dial gauge about 5mm (0.2 in.) from the outer circumference of the brake disc, and measure the runout of the disc.

Brake disc runout

Limit: 0.04 mm (0.00157in.) or less (new one)

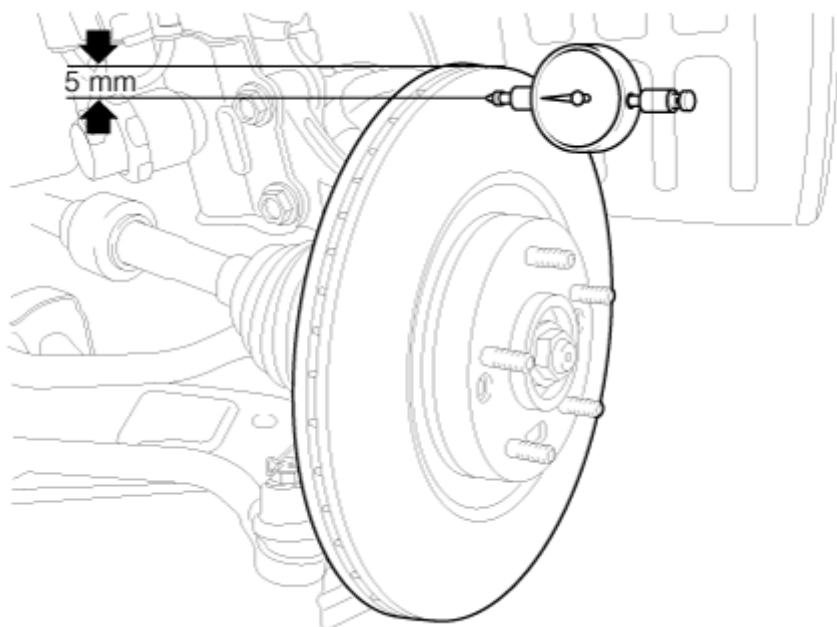

2. If the runout of the brake disc exceeds the limit specification, replace the disc, and then measure the runout again.
3. If the runout does not exceed the limit specification, install the brake disc after turning it 180° and then check the runout of the brake disc again.
4. If the runout cannot be corrected by changing the position of the brake disc, replace the brake disc.

Rear Brake

Rear brake disc thickness check

1. Check the brake pads for wear and fade.

2. Check the brake disc for damage and cracks.

English

3. Remove all rust and contamination from the surface, and measure the disc thickness at 8 points, at least, of same distance (5mm) from the brake disc outer circle.

Brake disc thickness

- 17 in Standard : 13.0 mm (0.51 in.)
 - 17 in Service limit : 11.4 mm (0.44 in.)
 - 18 in Standard : 22.0 mm (0.86 in.)
 - 18 in Service limit : 20.4 mm (0.80 in.)
- Deviation: Less than 0.005mm (0.0002in)

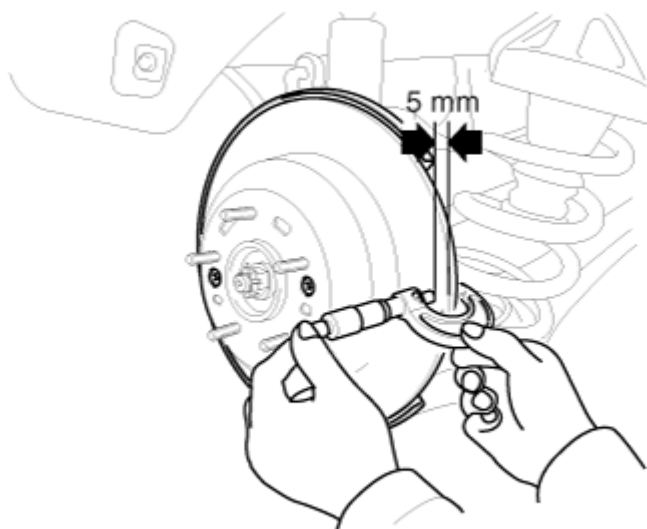

4. If wear exceeds the limit, replace the discs and pad assembly left and right of the vehicle.

Rear Brake Pad Check

1. Check the pad wear. Measure the pad thickness and replace it, if it is less than the specified value.

Pad thickness

- 17 in Standard value: 9.0 mm (0.35 in.)
- 18 in Standard value: 10 mm (0.39 in.)
- 17, 18 in Service limit: 2.0 mm (0.0787 in.)

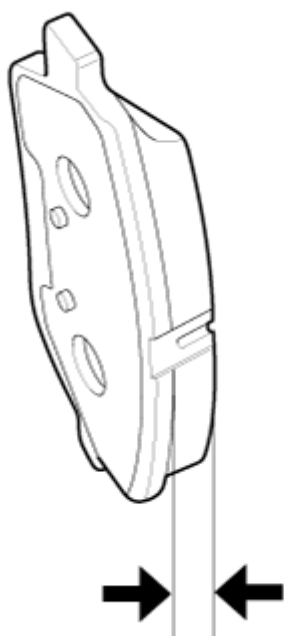

2. Check that grease is applied, to sliding contact points and the pad and backing metal for damage.

Rear brake disc runout check

1. Place a dial gauge about 5mm (0.2 in.) from the outer circumference of the brake disc, and measure the runout of the disc.

Brake disc runout

Limit: 0.03 mm (0.00118 in.) or less (new one)

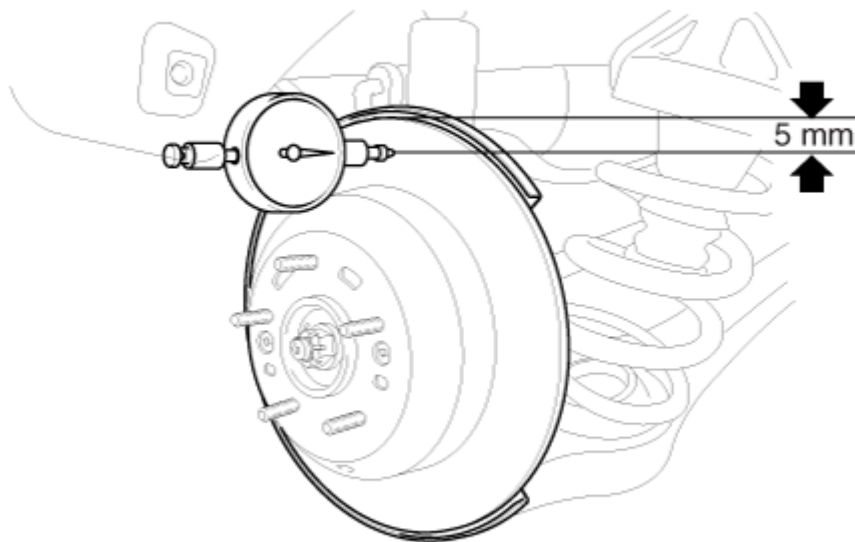

2. If the runout of the brake disc exceeds the limit specification, replace the disc, and then measure the runout again.
3. If the runout exceeds the limit specification, install the brake disc after turning it 180° and then check the runout of the brake disc again.
4. If the runout cannot be corrected by changing the position of the brake disc, replace the brake disc.

*** Thanks for your cooperation for the more quality. Please surely rate this document before closing.**